

# SMART TABLE FOOTBALL GAME



**MIGHTYMAST  
LEISURE**

## ASSEMBLY INSTRUCTIONS

Please keep for future reference  
Adult Assembly Required

(0316)

## **ASSEMBLY INSTRUCTIONS**

Please keep these instructions for future reference. Adult assembly required.  
This table is not a toy & is intended for use by or under the supervision of adults.  
Please do not sit, climb or lean on the table.  
This table is intended for indoor use only.

1. Find a clean & level place to begin the assembly of your SMART table football game. You will need a Phillips screwdriver & a hammer. Remove all parts from the box & save all packing materials until the parts have been inspected & the table is assembled.
2. The fold-up legs are already pre-assembled for your convenience. Fit the rubber feet to the bottom of each of the 4 legs if not already attached. Stand the table up on its legs & prepare to fit the poles. Next, slide the thin bars into the thick bars as shown below:

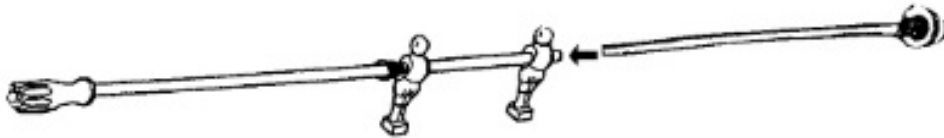

3. Push the bars into the table, pushing the handle-end of the pole through the hole first from the inside. Do not fit the handles onto the poles at this stage.

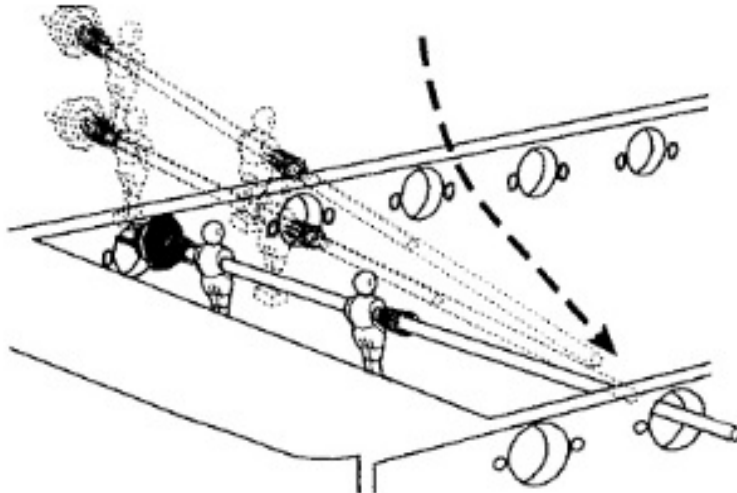

Then starting from the blue score counters end of the table insert the poles as follows:

- Blue 1-man pole
- Blue 2-man pole
- Red 3-man pole
- Blue 5-man pole
- Red 5-man pole
- Blue 3-man pole
- Red 2-man pole
- Red 1-man pole

There should now be 4 poles on each side of the table with the blue & red teams facing each other.

- Next, put the rubber washers into the 8 flat-end plastic caps. Push the bearing fitted to the thin rod into the hole & fit the flat cap from outside, making sure that the 'legs' on the inside bearing line up with the screw holes on the end cap. Secure with 2 screws but do not over-tighten.

At the handle end of the pole put 2 half-bearings with 'legs' on to the bar from the inside & push into the hole. Now put 2 half-bearings without 'legs' on from the outside, making sure again that the holes line up with the 'legs' on the inside bearings. Insert the screws & tighten. Finally hammer on the handles to the ends of the poles.

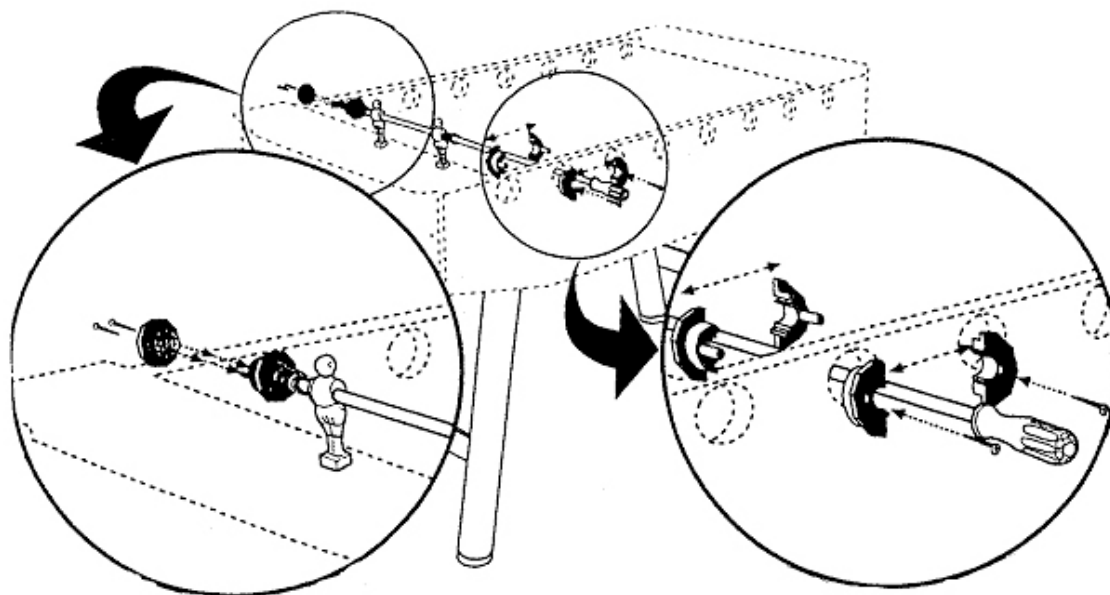

- If not already fitted, attach the 2 plastic top ends to the top of the table with the 12 screws provided. The blue & red score cubes can then be screwed into these top ends with the 4 long screws provided.

**You are now ready to play**

### Cleaning & Maintenance

Use everyday household glass cleaner for both the glass & the laminate surface.



**Mightymast Leisure is the UK & Ireland agent for FAS Italian table football games**

For sales & service contact:

Mightymast Leisure Ltd, 58 Bentwaters Park, Rendlesham, Woodbridge, Suffolk. IP12 2TW. UK

Tel: +44 (0)1394-460896

[www.mightymast.com](http://www.mightymast.com)

[info@mightymast.com](mailto:info@mightymast.com)